

STANDARD SPECIFICATION

New Upgraded 'Full Sail-Away' Specification €979,000

LENGTH OVERALL	15.24 m	50 ft
WATERLINE LENGTH	13.68 m	44.86 ft
BEAM OVERALL	4.50 m	14.76 ft
BEAM WATERLINE	3.80 m	12.47 ft
DRAFT	2.30 m	7.54 ft
AIR DRAFT	24.8 m	81.35 ft
DISPLACEMENT (LIGHT SHIP)	19,000 kg	41,888 lb
DISPLACEMENT (FULL LOAD)	23,000 kg	50,706 lb
BALLAST WEIGHT	6,500 kg	14,330 lb
BALLAST RATIO	34.2%	
SAIL AREA	134.2 sq. m	1444.52 sq. ft
MAIN SAIL AREA	82.35 sq. m	886.39 sq. ft
GENOA (140%) SAIL AREA	74 sq. m	796.53 sq. ft
JIB (100%) SAIL AREA	50.77 sq. m	546.53 sq. ft
SAIL AREA DISPLACEMENT RATIO	19.2	
ENGINE POWER	59 KW	80 HP
FUEL TANKS (ALUMINIUM x 3)	845 litres	223 gallons
FRESH WATER TANKS (S-STEEL x 2)	560 litres	148 gallons
BLACK WATER TANKS (GRP x 2)	180 litres	48 gallons
GREY WATER TANKS (GRP)	300 litres	79 gallons
DESIGN CATEGORY	RCD CATEGORY 'A' OCEAN	

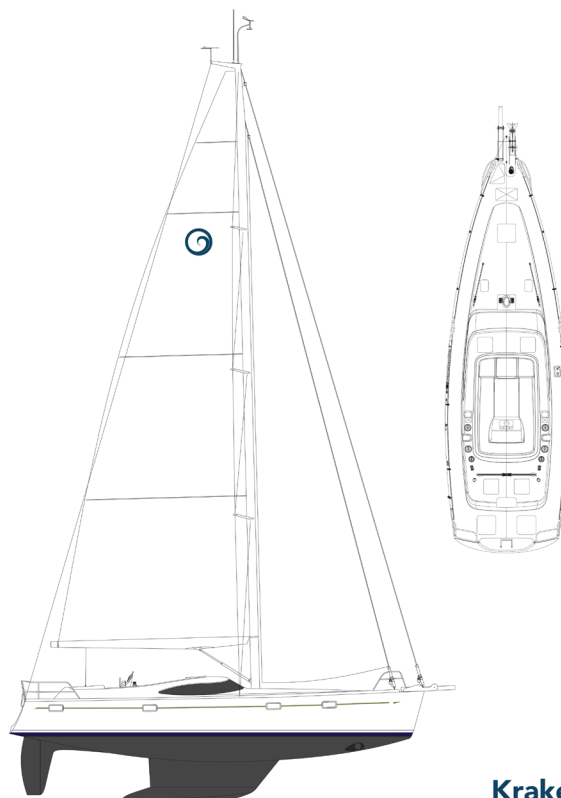

Kraken 50

The Kraken 50 is the perfect blue water cruiser for short-handed crews. She also accommodates up to eight crew in comfort, according to the layout chosen.

As with all Kraken yachts, the Kraken 50 is built with a very robust construction process and design features specifically tailored to enable her crew to explore the world.

The K50 is built with the integral ZERO™ Keel and the ALPHA™ Rudder System which incorporates a full length skeg which protects the rudder from collision damage from floating debris or grounding.

The Kraken 50 hull layup comprises 17-22 layers of composite fibres including aramid (Kevlar) engineered fabric, laminated in a vinyl ester resin system. It's 18mm construction provides far greater impact resistance and enjoys more integral strength than any other GRP or Aluminium yacht in production today.

All Kraken yachts feature the versatile Solent dual headsail rig as standard. The specification of the rigging is deliberately overbuilt to withstand the rigours of ocean sailing.

Please note: The Kraken 50's standard specification is full sail-away and many items of equipment that are normally found as upgrades or options are already included.

BUILD SPECIFICATION

HULL, DECK, KEEL AND RUDDER

- One piece hull and keel, featuring the unique Zero Keel with internal lead ballast. Solid fiberglass hull of a general layup thickness of 18mm below the waterline extending 40cm above. Stiffness, rigidity and strength as well as excellent thermal insulation is achieved by the foam cored topsides.
- The hull layup comprises 17-22 layers of FRP composites with engineered fabrics including aramid fibres.
- Kevlar™ reinforcements in impact area of forebody and leading edge of ZERO™ Keel.
- Heavily reinforced 'crash zone' below anchor chain locker incorporating high density foam, Kevlar™ and substantial reinforcements and extending above the waterline by 40cm.

- Structural components are individually bonded during the hull layup stages with no prefabricated structural components used.
- Vacuum bonded foam cored deck and superstructure with high density inserts and single layer GRP laminates in load bearing regions. Deck hardware is mounted to areas of extra reinforcement and strength.
- Sealed waterproof bulkheads protect the bow and transom area forward and aft.
- All bulkheads are foam cored and FRP laminated for maximum strength and rigidity.
- Integral Kraken moulded safety bulwark with concave internal surface for superior deck safety at sea.
- ALPHA™ Rudder System with full length skeg supported rudder. Integral stainless steel bonded reinforcing armature from hull to lower skeg with with stainless steel shoe. This provides additional impact resistance and strength to the steering system. This unique system also allows the main rudder bearing to be maintained or repaired in water.
- GRP moulded deck with Flexiteek™ synthetic teak decking to cockpit sole and side decking. Non-slip gel coat fore and aft coachroofs.
- Ultra-high impact resistant glass in wrap around saloon windows. Port lights in hull.
- Standard hull gelcoat colour Signal White. Many colour option available, owners choice.
- 3 x coats of primer and sealer applied below the waterline before standard antifoul in dark grey - other colours available upon request.
- Designed and built to meet and exceed RCD Category 'A' - Ocean, ABYC or local area equivalent at client request.

DECK EQUIPMENT

ELECTRIC IN-MAST FURLING

- Seldén anodized aluminium 3x spreader furling mast.
- Admiral electric in-mast furling.
- Seldén anodized aluminium boom with ball bearing outhaul car.
- Seldén mechanical rigid vang.

MAST & RIGGING

- Dual headsail Solent rig for easy handling and performance at all points of sail. The ultimate blue water cruising rig with coachroof mounted tracks for jib cars for upwind sailing.
- Two Admiral manual foresail furlers with lead blocks to cockpit and rope clutches for control of furling lines from the safety of the cockpit.
- 10-14mm 1x19 Dyform stainless steel wire standing rigging.
- Mast mounted halyard racks for foresail halyards - to reduce rope quantity and deck loads and to utilise cockpit winches for halyard controls for safe and easy sail handling.
- All halyards are Dyneema, all sheets, furling lines and other utility lines are multicored sheaved polyester.
- All halyards run below deck in channels, eliminating tripping hazards.

SAILS

- Quantum Sails™ Dacron crosscut mainsail.
- Quantum Sails™ Dacron crosscut upwind furling jib with UV strips.
- Quantum Sails™ Dacron crosscut 140% reaching genoa with UV strip.

DECK HARDWARE

- High-level stainless-steel stanchions & triple lifelines on top of bulwark for clear decks, reduced tripping hazards and ease of cleaning. Stanchion bases incorporate strong points for securing barber haulers or downhauls or for safety harness attachment.
- Padeyes mounted to deck for attachment of jacklines x 6.
- Stainless steel pushpit.
- Side deck boarding gates port and starboard with incorporated boarding ladder to ease boarding and to avoid the need to climb over lifelines when coming alongside.
- Split pulpit on bow for ease of access to bow area during anchoring and flying sail use.
- Stainless steel grab rails mounted to coachroof for safe foredeck access.
- Kraken Stainless-steel heavy-duty cleats mounted to stainless base plate with bulwark fairleads x 6 - (2 x fore, 2 x midships, 2 x aft).
- Harken Radial 60ST self-tailing primary winches x 2 – Electric.
- Harken Radial 60ST self-tailing secondary/utility winches x 2 - for halyards, jib sheets and reefing – Electric.
- Harken Radial 50ST self-tailing mainsheet and traveller winches x 2 – Manual.
- Spinlock rope clutches and deck organiser for the topping lift and halyard controls.
- Harken mainsheet traveller and car with 2:1 purchase. Dual mainsheet controls, port and starboard.
- Fore deck sail locker / lazarette with watertight bulkhead to chain locker and second structural bulkhead to interior. Fitted with lockable latch hardware.
- Lewmar opening flush deck hatches. (Number subject to layout)
- Foredeck seawater and freshwater wash down pump and deck connector.

ANCHORING

- Dual roller, heavy duty bow roller system incorporating mounting for optional bow sprit for the use of asymmetric spinnaker, furling code k or other flying sail option.
- Maxwell RC10 24VDC electric anchor windlass with chain and rode compatible gypsy. Deck mounted foot switches and pedestal controls included.
- Deck access chain locker to assist with the recovery of chain during anchoring operations.
- Unique Kraken chain locker design to reduce the build up of chain during anchor recovery and to improve drainage of the chain locker.
- Lewmar Delta 40kg anchor. 100m of 10mm chain + 40m of octoplait.

HELM AND COCKPIT

- Kraken solid plexiglass / stainless steel wind screen.
- Soft top, tubular stainless steel bimini with Ferrari Stamoid top. Includes removable forward and side panels and fitted bimini lights.
- Bespoke Kraken steering pedestal and console.
- Plastimo Horizon 135 compass mounted to pedestal.
- Raised helm floor to enable uninterrupted visibility forward.
- Moulded foot braces port and starboard at the helm position for bracing whilst under sail on either tack.
- Stainless steel helm wheel, Jefa Steering 1200 mm.
- Jefa Steering torque tube system with integrated autopilot drive.

- Emergency tiller with deck access to rudder stock.
- Teak cockpit table with stainless steel grabrail, foot brace support, cupholders and storage lockers. Oiled finish
- Ergonomic layout of sail controls to allow operation of sail controls by shorthanded crews.
- Plexiglass sliding companionway hatch.
- A unique Kraken vertical sliding plexiglass storm board with adjustable height control system. This replaces multiple storm boards that are a danger to the crew and the yacht.
- Opening portlights to cockpit well x 4 - galley, master cabin, shower and engine room.
- Cockpit cushions in Textilene with fast drain foam interior. Fast mount attachments.

TRANSOM

- Three hatches to large aft lazarette locker and one dedicated life raft locker. All with lockable latches.
- Dedicated emergency steering tiller & grab bag locker.
- Fold out swim platform.
- Transom steps.
- Stainless steel pushpit gate to swim platform.
- Diving / swim ladder with oval steps to ease re-boarding from the water.
- Aft deck seawater and freshwater wash down pump and deck connector.

ENGINE AND PROPULSION

- Yanmar™, 80HP - 4JH80 - Common-rail diesel engine supported by flexible mounts.
- Vetus 95kgf 24V bow thruster with dedicated battery (175Ah 24VDC) and charger.
- Stainless steel propeller shaft 1.5" (F51 Duplex) supported by custom 'V' bracket and dripless shaft seal.
- Bruntons Sigmadrive™ flexible coupling for isolation of vibration from engine to hull.
- Bruntons Autoprop™ self-pitching propeller.
- Engine start panel and tachometer mounted in cockpit.
- Single lever engine control on steering pedestal.
- 125A@12VDC alternator.
- Vetus PVC engine cooling water strainer with removable filter.
- Engine space and machinery room isolated with vibration dampening plate and 40mm (1.5") acoustic insulation and protected with painted aluminium liner. High specification fire retardant materials and acoustic insulation for quiet running under power.

FUEL SYSTEM

- Kraken triple fuel tank and polishing system provides essential fuel system maintenance and engine reliability. The system incorporates a single cup primary filter and dual cup dedicated engine filter, installed within machinery room for ease of access and maintenance. The use of a running tank to store clean fuel combined with the fuel filters ensures only clean fuel is delivered to the engine or generator. Cleaning of fuel can be undertaken from any tank to any other tank and this will remove contaminants from the fuel to ensure reliable service of the engine no matter the quality of the fuel delivered to the storage tanks.
- Kraken designed recessed eco deck fuel filling station ensures no contamination can occur through deck fillers and any spillages are retained within the fuel filling locker.

NAVIGATION AND COMMUNICATIONS

- Garmin™ Wind, Speed and Depth transducers.
- Garmin™ GPSMAP 923xsv 9" Chartplotter at the navigation station.
- Garmin™ GPSMAP 923xsv 9" Chartplotter at the helm.
- Garmin™ VHF 115 handset and speakers at chart table.
- Garmin™ Reactor™ 40 autopilot with autopilot GHC™ 20 at the helm.

ELECTRICAL SYSTEMS

GENERATOR

- Cummins Onan 7kW generator including sound shield for quiet operation.

DC ELECTRICS

- AGM House Batteries 720Ah at 24V. (6x 240Ah@12V)
- AGM Engine and generator start batteries x 2, 12v, 110Ah.
- AGM Bow thruster / windlass battery 24v, 240Ah.
- Heavy duty battery change over and twinning switch.
- 12V/24V electrical distribution panel - Remote battery isolator switches.
- Victron Quattro 8000VA Charger / Inverter.
- Victron 24VDC to 12VDC converter for navigation electronics.
- LED ceiling lights, reading lights and hanging locker lights.
- LED Chart table light (red / white).
- LED spreader lights, downward pointing on lower spreader.
- Aqua Series 4 LED Navigation lights - deck level port, starboard and stern lights.
- 24VDC machinery space / Engine room blower.
- Electric bilge pumps x 4, Bilge pump float switches and alarm panel and manual override.
- Additional very high volume bilge pump (14,000 l/h) for emergency flooding control inclusive of high level sensor and alarm.

AC ELECTRICS

- 15m Shore power cable.
- Shore power sockets, stainless steel x 2 in both forward and aft lazarettes.
- 110V or 220V electrical distribution panel – Owners choice.
- AC multi standard sockets with USB charger in cabins, at chart table, saloon and galley. (Quantity and position is layout dependent)
- Shore power galvanic isolator for reduced galvanic corrosion whilst connected to shore power supply.

PLUMBING

- Pressurised hot and cold water system.
- Electric sump pumps in all showers.
- Main engine / 220VAC dual element hot water calorifier 42 litres.
- All heads include holding tanks with gravity discharge and deck pump out fittings.

- Separate grey water tank for each head with electric pump discharge deck pump out fitting.

INTERIOR

INTERIOR FINISH

- Interior joinery in white oak, afromosia or cherry using selected timbers and decorative veneers.
- Cabin sole in oak, walnut or afromosia.
- Concealed hinges and quality latches on locker doors and solid timber doors frames.
- High quality marine fabrics for cushions and headboards.
- Lee cloths or folding lee boards per berth.
- Removable vinyl head lining panels using Fastmount™.
- Smoke detectors throughout. Carbon monoxide detector in engine room. (number of smoke detectors dependent on layout selected).

INTERIOR NAVIGATION/PILOT STATION

- Raise full view self contained navigation/ pilot station with chart table and instrument consol. This enables the crew to carry out watches in the warmth of the saloon.
- Secure and comfortable navigation chair incorporating grab rail and side support.

DOMESTIC SYSTEMS

- Webasto Full tropical air-conditioning system with reverse air cycle heating.
- Fully gimballed, GN Espace OceanChef 3 Induction Cooker. See [website](#) for details.
- Stainless grab rail / safety rail to protect accidental contact with cooker.
- Built in Vitrifrigo stainless steel 24VDC double drawer style fridge 144L – supplied with keel cooler for efficient cooling in all climates. See [website](#) for details.
- Built in Vitrifrigo stainless steel 24VDC single drawer style freezer 75L - supplied with keel cooler for efficient cooling in all climates. See [website](#) for details.
- Hydromaster 180l/h Watermaker.
- Kraken dual purpose bins. Two garbage bins alongside each other to enable the disposal of biodegradable waste overboard as well as deep bin for non biodegradable shore side disposal of non-bio degradable waste.
- Blanco single stainless steel sink with chopping board cover in Galley.
- HI MACS™ Alpine White (natural acrylic stone) sinks in heads.
- Solid stainless steel taps and bathroom fittings throughout.
- Plexiglass bifold doors to all showers.
- HI MACS™ (natural acrylic stone) worktops and head surfaces with moulded fiddle rail to make cleaning and maintenance of surfaces easy.
- Vetus electric toilets, sea water flushing.
- 4x fire extinguishers throughout and 1x fire-blanket in the galley.

INTERIOR FITTINGS

- Solid timber and real wood veneer saloon table with fixed pedestal. Large amounts of storage space throughout.
- Large access panels to bilges, fuel and water tanks with large access hatches in all tanks.
- Solid laminated timber / stainless steel tubular companionway. Steps with angled ends allow safe use at sea.

- Access panel beneath companionway steps with removable panel to engine for improved access for servicing. Acoustic and thermal insulation for quiet accommodation spaces.
- Overhead hatches and ventilation throughout.
- Raised deck saloon provides excellent all round visibility through high specification impact resistant laminated glass.
- Dedicated wet locker with warm air supply close to companionway for the storage of wet-weather gear and lifejackets.
- Headboards in selected high-quality fabrics.
- Hinged lifting access on gas struts to storage beneath of master cabin double berth.
- Large capacity drawers under each berth.

SAFETY EQUIPMENT

- Fire extinguishers x6. (subject to layout)
- Horseshoe life ring and beacon.
- Fire blanket.
- Manual bilge pump in cockpit.
- Automatic engine room fire suppression system with manual override.

ANCILLARY ITEMS

- 6 x F7 fenders.
- Boathook
- 4 x 22mm nylon 3 strand mooring warps, 15m.
- 3 x Winch handles.
- Full owners manual and vessel introduction.

Layout Example Three Cabin - One double berth cabin, one double bunk cabin and one single bunk cabin

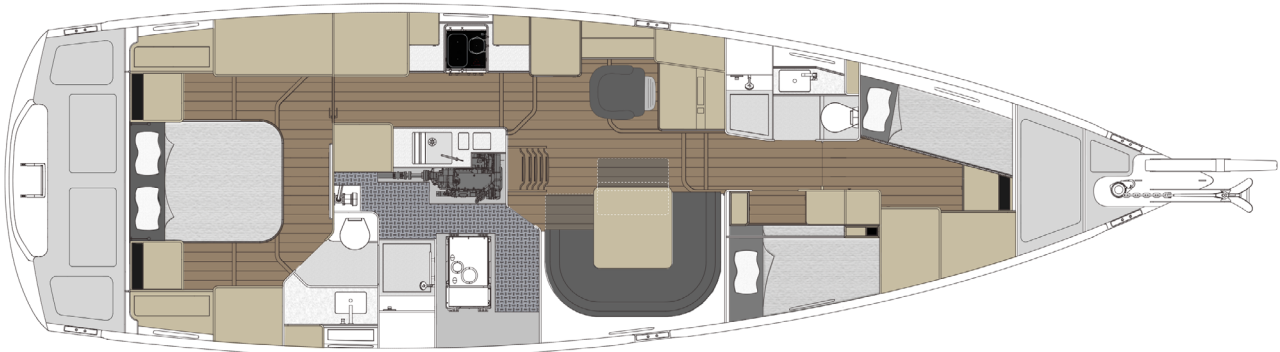

Alternative four, five or six berth layouts available. See brochure or our [website](#).

This is one example of a completed layout however with our modular approach to interior layouts, owners can mix and match each section of the yacht to build their perfect layout. Further customisation is available in the design stage prior to the build slot date.

Standard Specification as Above €979,000

BUILD SPECIFICATION

Non-standard hull colour
 Upgrade to Coppercoat antifouling
 Stainless Steel Tube Top Guard Rail
Flexiteek™ synthetic teak decking (2 options)

Side decks, forward coachroof and cockpit sole
 Side decks, forward, aft, and saloon coachroofs and cockpit sole

Solid strip planked teak (3 options)

Side decks and cockpit sole
 Side decks, forward coachroof and cockpit sole
 Side decks, forward, aft, and saloon coachroofs and cockpit sole

MAST AND MAINSAIL FURLING OPTIONS

Electric Automatic Outhaul (In-mast)
 White painted mast and boom upgrade

Slab Reef

- Selden white painted 3 x spreader mast.
- Harken Switch Track with 5 intermediate cars, 6 batten cars and 1 head car.
- White painted Park Avenue Boom with ball bearing outhaul car, integrated lazy jack and awning tracks.
- Selden mechanical rigid vang.

Electric in-boom furling - Romar Leisurefurl™

SAIL UPGRADES

Quantum Sail Wardrobe Upgrade 1 - Dacron Polyester Radial Cut
 Quantum Sail Wardrobe Upgrade 2 - Hybrid Spectra Radial Cut
 Quantum Sail Wardrobe Upgrade 3 - Hydra Net Radial Cut

DOWNWIND CRUISING

Downwind Flying Headsail Pack - Quantum Code K headsail, continuous furler, furling line and blocks, carbon bowsprit, carbon pole and sheets

Second Headsail Pole – Carbon fibre, on mast storage with track, including downhaul, uphaul, snatch blocks and line driver for pole height adjustment. For poling out dual headsail combinations of Code K, Genoa or Jib when running ‘butterfly’ dual headsails downwind.

Quantum Sails asymmetrical cruising chute with snuffer and sheets

DECK EQUIPMENT

Upgrade mainsheet Harken cockpit winches to 24V electric. Cockpit coaming mounted control switches

Upgrade both foresail furlers to electric from standard manual drum furlers

Tweaker snatch block pack with clutchcleats x2

Kraken davits with manual operation - Stainless steel

Upgrade stainless steel davits to electric operation

Bofor watertight hatch between forward lazarette and chainlocker

G&T teak seats on pushpit corners

Folding carbon fibre passarelle with handrail and holdall bag

Folding aluminium passarelle with handrail

Stern-to mooring line pack - 2x Mooring line and 2x chain

Ultra dyneema mooring line pack storage reels mounted at stern x2

Spur Shaft cutter – Marine ‘Stripper’ 3 Blade

Transom shower with flexible hose

COCKPIT AND HELM

GRP hard top bimini with plexiglass screen and removable flexible side screens. (Instead of rigid flexible bimini)

Upgrade stainless steel helm wheel to carbon fibre

Teak cockpit table varnished instead of oiled

Cockpit Protective Cover Pack
 - Wheel and pedestal
 - Cockpit table
 - Winches
 - Clutch cleats

ELECTRICAL SYSTEMS

Upgrade Victron inverter / chargers to 2x Quattro 5000

Additional high output alternator for charging house bank

Upgrade house battery bank to MG lithium LiFePO4 Batteries 24V 840Ah (further upgrades available)

Upgrade standard DC electrical system to Digital Switching

Standard Specification as Above €979,000

Freedom Electrical Pack

A truly go-anywhere electrical shore power system that can utilise 110-120 volt x 60Hz , 220-240 volt x 50Hz of shore power and even 220-240 x 60Hz. Including Victron inverter / chargers to 1x Quattro 5000kVA 1x Quattro 8000kVA

Additional LED Spreader lights on lower spreader (upward and downward pointing)

Additional LED Spreader lights on all spreaders (upward and downward pointing)

Masthead tri colour navigation lights

HYBRID DRIVE SYSTEM

Hybrid Marine V Drive System based on Yanmar 4JH57 (57HP) or Beta Marine 60HP engine MG LiFePO4 lithium battery bank upgrade Bruntons Auto Prop ECO

SOLAR PANELS

1x 104w Solbian semi-flexible panel

2x 104w Solbian semi-flexible panel

4x 104w Solbian semi-flexible panel

NAVIGATION AND COMMUNICATIONS

Garmin Offshore Pack

1x GPSMAP 1022 Plus 10' MFD plotter with manual controls for helm
1x GPSMAP 8410 10' MFD plotter with touch screen for nav station
1x GMR™ 18 xHD Radome
1x Reactor 40 Mechanical/Solenoid Autopilot with 1x GHC auto pilot controls
1x GNX wired sail pack 43, wind, depth and speed includes 2 x GNX data screens
1x VHF 215 Marine radio
1x GHS 11 second station VHF handset.
1x ACTIVE SPEAKER with volume control
1x AIS 800 Blackbox Transceiver

Garmin Ocean Pack

1x GPSMAP 1222XSV 12" MFD plotter with manual controls for helm
1x GPSMAP 8416 12" MFD plotter with touch control for Nav station
1x GRID 20 remote manual control for Nav station
1x Reactor 40 Autopilot with 2 x GHC auto pilot controls
1x GNI/GNX wired sail pack 52, wind, depth and speed includes 1 x GNI colour wind/data screen plus 1 x GNX data screen at helm
1x GNI wired colour wind/data screen, 1x GNX wired mono data screen at nav station.
1x GMR 24xHD Radar
1x VHF 315 Marine radio
1x GHS 11 second station VHF handset
1x AIS 800 Blackbox Transceiver

Garmin World Pack

1x GPSMAP 1222 XSV 12" MFD plotter with manual controls for helm
1x GPSMAP 8412 XSV 12" MFD plotter with touch control for Nav station
1x GRID 20 remote manual control for nav station MFD
1x GPSMAP 922 XSV PLUS 9" Plotter in master cabin
1x GMR Fantom™ 18 Radome
1x Reactor 40 Autopilot Mechanical/Solenoid with 2X GHC auto pilot controls
1x GNI/GNX wired sail pack 52, wind, depth and speed includes 1 x GNI wired colour wind/data screen at helm
1x GNI wired colour wind/data screen plus 1x GNX mono data screen Nav station
1x VHF 315 Marine radio
1x GHS 11 second station VHF handset.
1x AIS 800 Blackbox Transceiver
1x GT50M transducer for Chirp/Side Vu/Clear Vu
1x Panoptix PS51 forward sonar transducer 2D

Inmarsat Fleet One Satellite Communication Pack

- Sailor Fleet One unit mounted to mast
- Sailor below decks unit
- Thane IP handset
- Mailasail Red Box - compact wireless router integrating satellite communications, 4G and WiFi. Smart firewall to optimise speed, traffic and overspend

Upgrade Satellite pack to Iridium Certus, providing speeds up to 704 Kbps. Perfect for boatowners who wish to work remotely onboard.

AUDIO VISUAL

Fusion Saloon Pack - Apollo RA770 stereo, speakers and USB auxiliary connector.

Fusion Master Cabin AV Pack - Apollo RA670 stereo unit, 2 speakers, USB auxiliary connector and a 43" Samsung flatscreen television.

DOMESTIC SYSTEMS

Air Conditioning Upgrade Pack

Chilled water centralised air conditioning system with air handlers throughout.
Webasto warm air heating system for high latitude sailing

Bosch combi clothes washer and dryer

Add additional Vitrifrego drawer freezer 24VDC 75L

Manual water tap at galley sink with fresh or salt water switchover

Upgrade galley tap to Quooker fusion boiling water and mixer tap

Seawater / freshwater switchover for electric toilets.

Vitrifrego Ice Maker

INTERIOR OPTIONS

Interior Hatch & Portlight Screen Pack

- Blinds for overhead deck hatches (mosquito and blackout)
- Roller blinds for portlights

Master cabin split mattress with additional fold up leeboard for the center of the double berth

Upgrade interior timber to teak

Upgrade cabin sole to afromosia with ash stripe solid planking

Upgrade cabin sole to teak solid planking

Upgrade cabin sole to teak & holly stripe solid planking

Electric adjustable saloon table pedestal. Allows the settee to be converted into a large double berth

Safe built into master cabin wardrobe

ANCILLARY EQUIPMENT

Bobtail 3.0m Hypalon and aluminium rib

10HP Yamaha outboard engine

Bobtail 3.3m Hypalon and aluminium rib

15HP Yamaha outboard engine

Pushpit mounted teak outboard bracket

Upgrade to stainless steel Ultra anchor (45kg)

27kg Kedge anchor with 10m chain + 50m Octoplait nylon anchor warp

Electric BBQ mounted on pushpit

Life Jacket pack x8

Viking 6 man life raft.

Offshore Safety Pack - EPIRB, hand flares x2, parachute flares x2, buoyant smoke and dan buoy and bracket

Utility Pack - Includes: 1x boat hook, 2x 20m hose, 1x 10m hose, Spray gun, 1x soft gelcoat brush, 1x non-skid brush, 1x boat soap, 2x sponge, 2x 10 gallon bucket, 2x chamois, window squeegee, 10x micro fibre cloths

K50 Tool Kit - comprises all tools required to fit and maintain all equipment on board.

Alkin W31 Mariner Vertical Dive Compressor

Standard Specification as Above €979,000

Other options you may require:

Comments or questions:

YOUR NAME:

CONTACT METHODS

MOBILE
/ CELL

PHONE

WhatsApp

FaceTime

Skype

PHONE NUMBER:

MOBILE / CELL
NUMBER: